

BAY 6 PARTS LIST

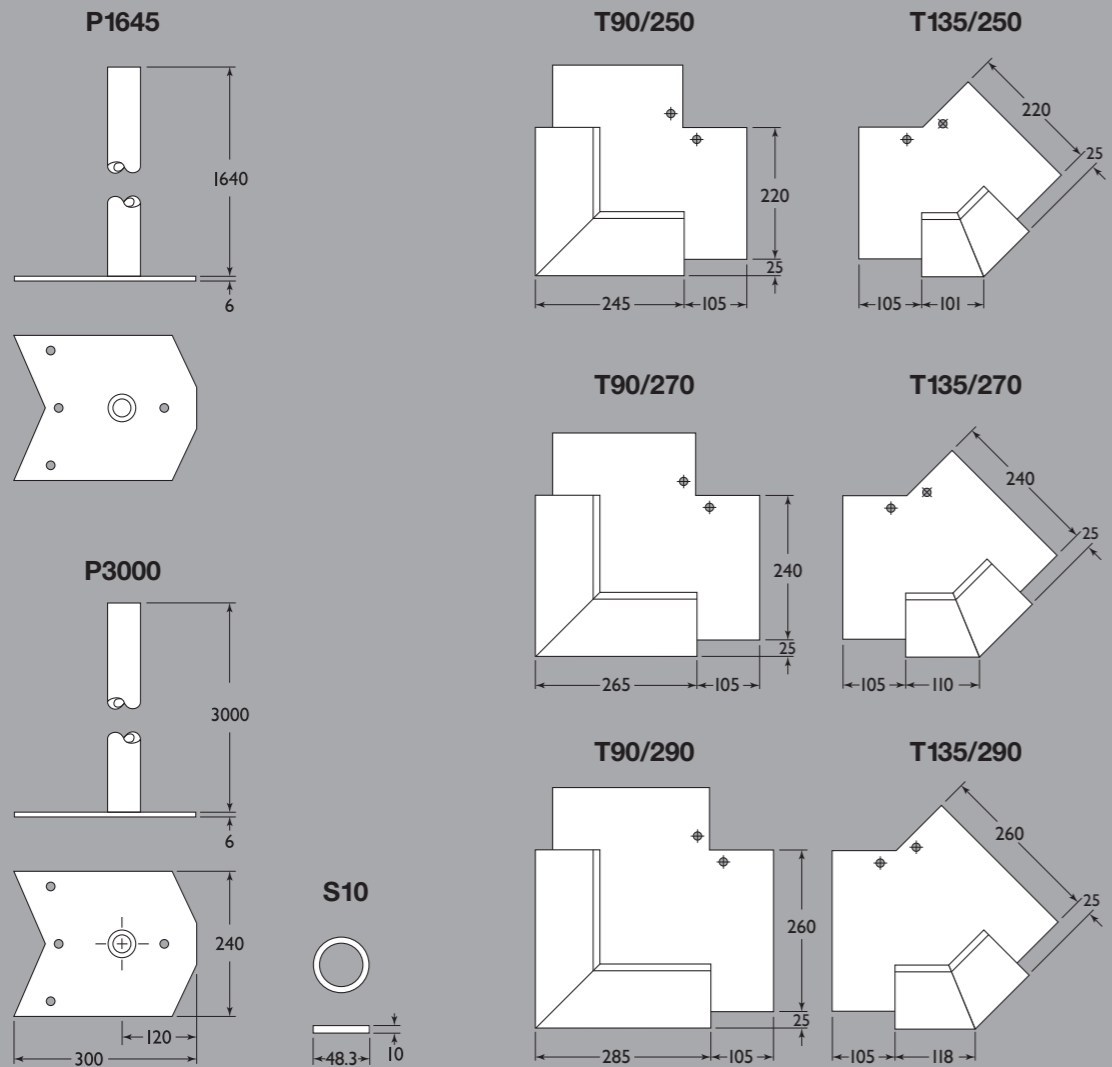

| part number | description | recommended lintel | weight (kg) |
|-------------|--------------------------------|--------------------|-------------|
| P1645 | support post - 1645 long | | 9 |
| P3000 | support post - 3000 long | | 14 |
| T90/250 | 90° cap plate - 250-265 walls | CB50 | 8 |
| T90/270 | 90° cap plate - 270-285 walls | CB70 | 8 |
| T90/290 | 90° cap plate - 290-300 walls | CB90 | 8 |
| T135/250 | 135° cap plate - 250-265 walls | CB50 | 7 |
| T135/270 | 135° cap plate - 270-285 walls | CB70 | 7 |
| T135/290 | 135° cap plate - 290-300 walls | CB90 | 7 |
| S10 | spacer shim - 10 deep | | |

All measurements are shown in millimetres.



Mary Avenue Birtley County Durham DH31JF
 Telephone 0191 410 6631
 Fax 0191 410 0650
 email info@birtley-building.co.uk
www.birtley-building.co.uk

NEW
FROM BIRTLEY

BAY 6 CORNER WINDOW SUPPORT SYSTEM

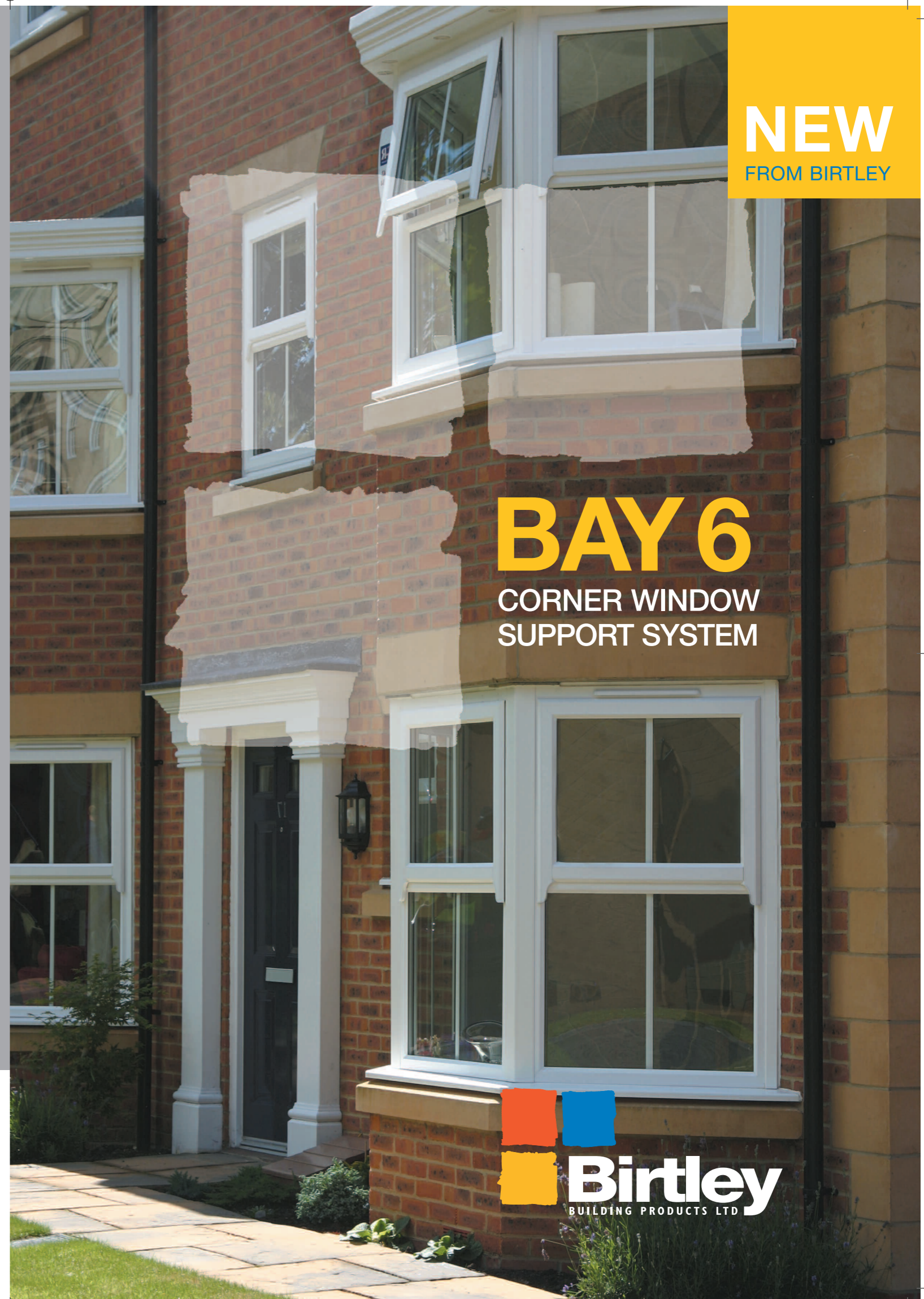

THE BIRTLEY BAY 6

CORNER WINDOW SUPPORT SYSTEM



The easy way to support cavity walls above corner windows, bay windows and sun lounges.

- Uses standard components available ex-stock
- Easy to transport and handle
- No special drawings or design work needed
- Suits most standard wall constructions
- Hot-dip galvanized after fabrication

System is intended for use in domestic loading conditions with timber floors and roofs. Do not use to support pre-cast concrete floors. If in doubt contact technical department for advice.

Standard ex-stock lintels have hole punched in each end of rear flange for galvanizing purposes, this locates over dowel on top plate of post cap

Cap plate manufactured in 6 types, to suit 90° and 135° angles, and for 50, 70, and 90 cavity widths, 150 long spigot on underside locates into post

Post stocked in two lengths, 1645 long for below sill fixing and 3000 long for fixing at foundation level (cut to required length on site) 48.3 dia x 5 circular section allows post to be rotated to desired position

All components are hot-dip galvanized after fabrication to BS1461.

With baseplate set 10mm from face of wall, post sits in cavity immediately behind outer leaf. This is the optimum position to accommodate post within junction of window frames.

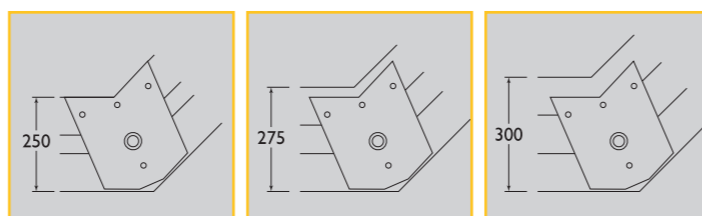
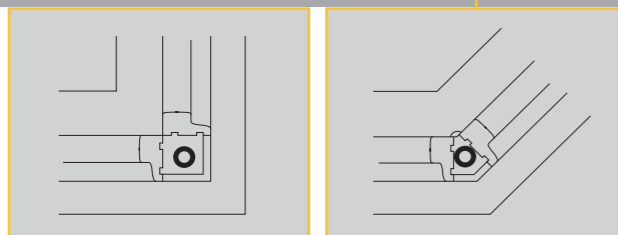
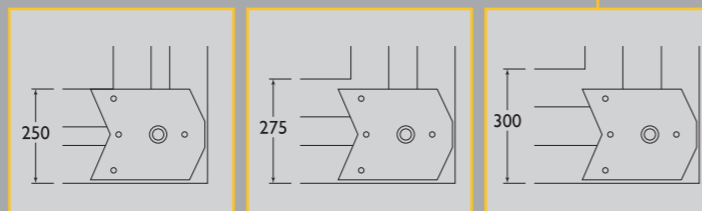
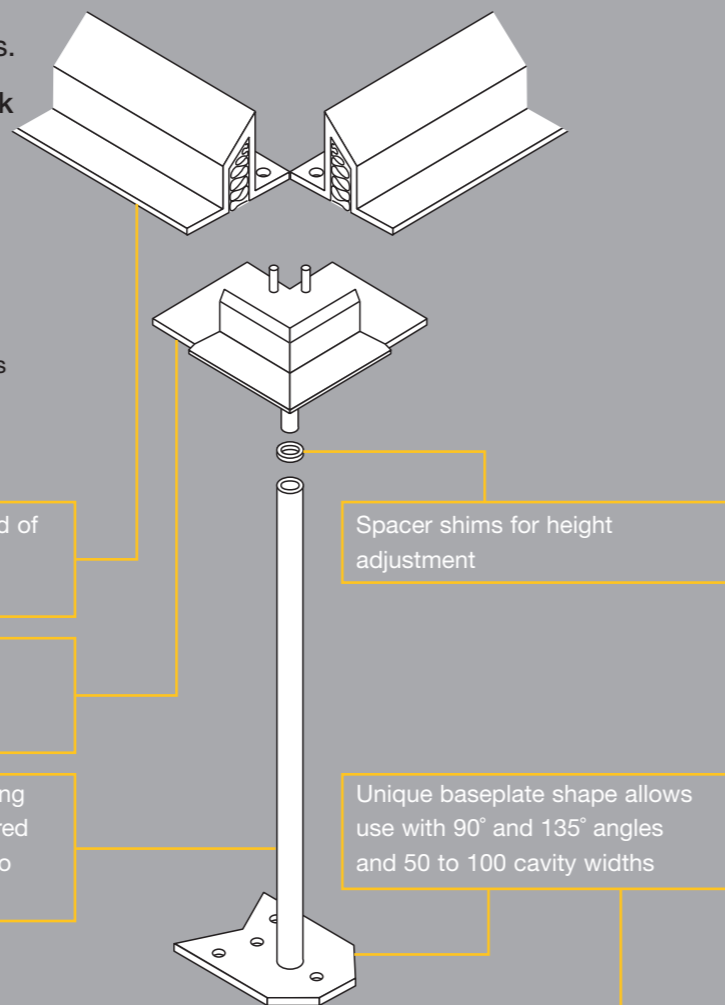

All measurements are shown in millimetres.

BAY 6 CONFIGURATIONS

All permutations of 90° and 135° angles can be accommodated. If standard length lintels do not suit site dimensions, they can be cut to required length on site. Cut edges should be treated with two coats of zinc-rich paint. 'Supergalv' lintels are hot-dip galvanized after fabrication. One of the features of this process is the self-healing properties of zinc by sacrificial action, (see 'Architects and Engineers Guide to Hot-dip galvanizing' published by the Galvanizers Association).

Loading: Maximum load applied to each post should not exceed 10 Kn.



EXAMPLES

